



The Bridge, King's Lynn, PE34 3PQ

Rent - £800 Per Month Deposit - £923

A fully refurbished flat finished to a high standard, located within an HMO-style building at Crown House, Stow Bridge.

The property offers a modern fitted kitchen and bathroom, along with a comfortable living area and cleverly designed pull-out bed space to maximise practicality. It also comes ready-fitted with a TV mount, making it easy for tenants to move in and settle straight away.

- FULLY REFURBISHED
- FITTED KITCHEN
- LIVING SPACE
- RIVER VIEWS
- COUNCIL TAX BAND - F
- HIGH SPECIFICATION
- MODERN BATHROOM
- UTILITIES INCLUDED (EXCLUDING ELECTRICITY)
- EPC RATING - B
- EARLY VIEWING ADVISED



Council Tax Band: F - EPC Rating: 0

GROUND FLOOR
17.9 sq.m. (193 sq.ft.) approx.

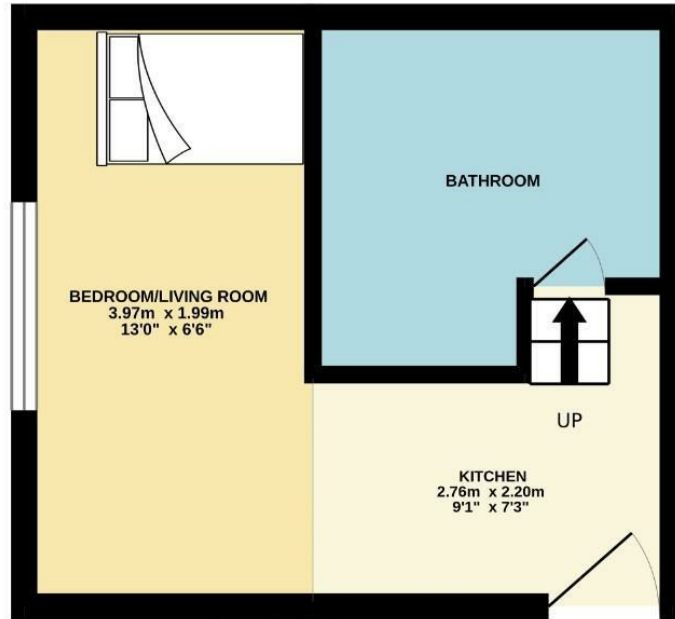

TOTAL FLOOR AREA: 17.9 sq.m. (193 sq.ft.) approx.
Whilst every attempt has been made to ensure the accuracy of the floorplan contained herein, measurements of doors, windows, rooms and any other items are approximate and no responsibility is taken for any error, omission or mis-statement. This plan is for illustrative purposes only and should be used as such by any prospective purchaser. The services, systems and appliances shown have not been tested and no guarantee as to their operability or efficiency can be given.
Made with Metropix ©2025

